

NPS (WSH-7) Non-Adjustable Vandal Resistant Shower Head (#370098)

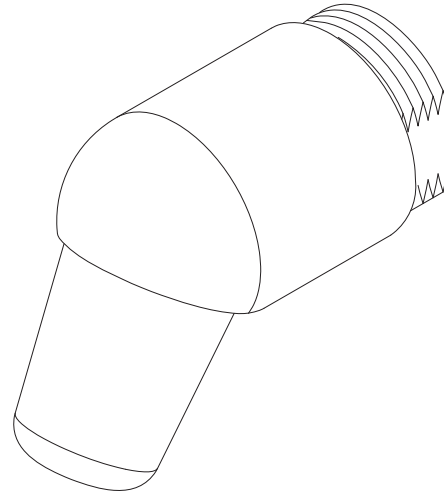

(Unit may be shown with optional features)

Recommended Specifications

Willoughby model NPS (WSH-7) non-adjustable, vandal resistant shower head shall be fixed type, constructed of Type 303 stainless steel, mounted from the rear with no visible fasteners or removable parts, and shall have a fixed 30° angle of spray with an adjustable pattern. The head shall have 3/8" F.I.P. threads on the inlet.

The shower head is non-adjustable from the user side. To adjust shower nozzle spray pattern, insert a 1/8" Allen wrench through the nozzle orifice when shower is not in use, and turn counterclockwise to widen spray pattern or clockwise to narrow the spray pattern.

OPTIONS:

- NPS17 17° angle of spray (#380011)

- 2.5 2.5 Flow (Standard)
- 2.0 2.0 In-line Flow Control
(See detail below; tubing must be 3/8" O.D. polyethylene)
- 1.5 1.5 In-line Flow Control
(See detail below; tubing must be 3/8" O.D. polyethylene)

PART #380142-XX (SPECIFY FLOW)
IN-LINE FLOW CONTROL ASSEMBLY

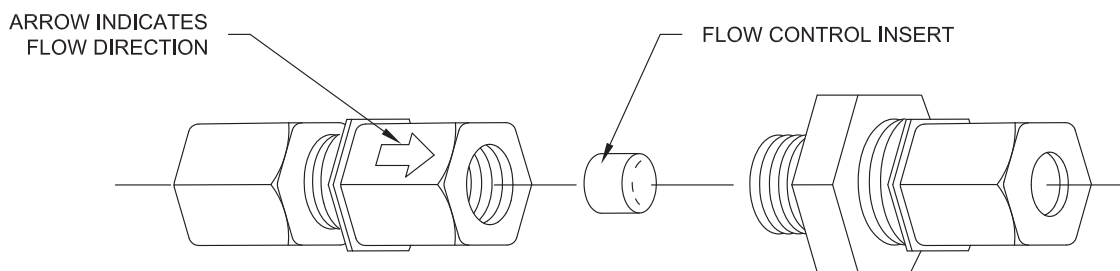

WARNING: Cancer and Reproductive Harm

- www.P65Warnings.ca.gov

visit our website at www.willoughby-ind.com
5105 West 78th Street • Indianapolis, IN. 46268
(317) 875-0830 • Fax: (317) 875-0837 • (800) 428-4065



MADE IN THE U.S.A.