

ELECTRONIC FLUSH VALVE - INSTALLATION

- 1) MOUNT VALVE (#1) TO VACUUM BREAKER W/ ARROW ON VALVE POINTING UP (AS SHOWN)
DO NOT OVER-TIGHTEN HOSE-CLAMP (#2)
- 2) INSERT 1/4" TUBES (#3) INTO VALVE AS SHOWN
- 3) INSERT OPPOSITE END OF TUBES TO "O" AND "L" POSITIONS ON FLUSHOMETER (#4) AS SHOWN

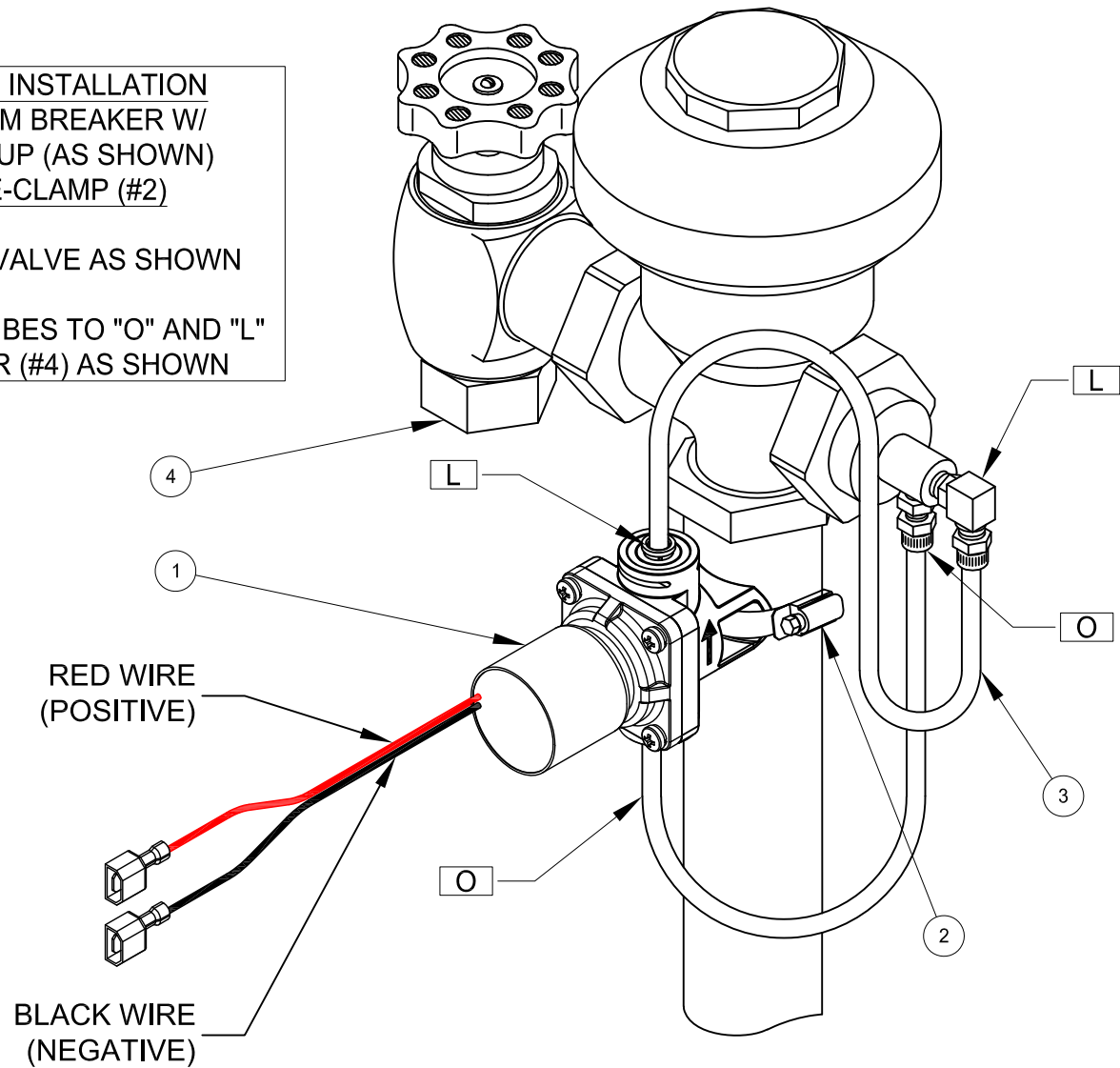

ITEM #	PART #	DESCRIPTION	QTY.
1	980630BO	VALVE SUB-ASSEMBLY, BATTERY OPERATED	1
2	980617	WORM GEAR PIPE CLAMP, 2"	1
3	390010	BLACK PLENUM TUBING, 1/4"OD X .170"ID X 4'	2
4	N/A	FLUSHOMETER (SOLD SEPARATE)	1



Willoughby Industries, Inc.
Indianapolis, Indiana

TOLERANCES
EXCEPT AS
NOTED

2 PLCS: ±0.03
3 PLCS: ±0.015
FRACTIONS: ±1/4"
ANGLE: ±1°

SIZE: A
SCALE: 1:6

TITLE / DESC:
MATL: SEE BOM
REF: 980635

EFVBO
BATTERY OPERATED ELECTRONIC FLUSH VALVE KIT

PART #:
980635BO

REVISION: A
ORIG.: NAL 11/11/19
REV.: NAL 11/11/19
STANDARD
SHEET: 1 OF 1