

## CWSMS-HCA Series Handicap Accessible Surface Mounted Wall Shower



### Recommended Specifications

Handicap Accessible, Surface Mounted Wall Shower shall be: Willoughby Model No. **CWSMS-HCA**  
(Select from model number and options list on next page)

Shower panel shall be fabricated from 18 gauge, Type 304 stainless steel with exposed stainless surfaces polished to a #4 satin finish. Sloped top panel and bottom panel are riveted onto the wall shower.

Standard equipment shall include:

- Shower valves (from Valve Selection options list)
- Shower heads (from Shower Head Selection options list)
- Z-clip mounting bracket
- (FX) Hand Held Flexshower head

Anchoring shall be by Z-clip and bottom flange with anchoring hardware by others. Shower unit shall be factory assembled, tested for proper operation, and ready for installation by a contractor. Unit requires no chase area for installation and maintenance.

Optional WaterSense Labeled ligature-resistant shower head available (LRSH).

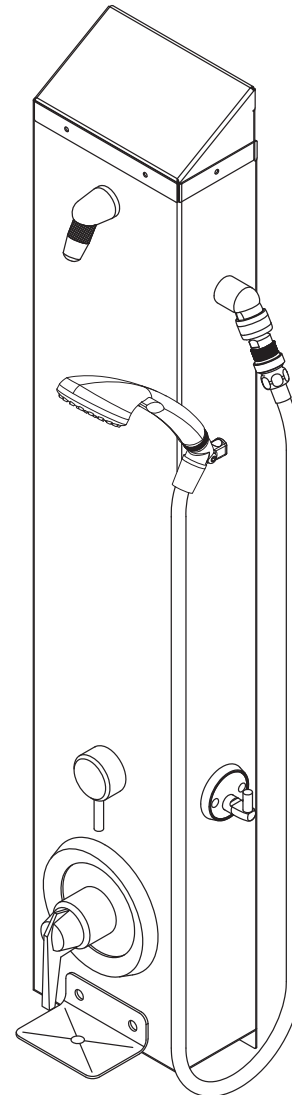

*(Unit may be shown with optional features)*

To specify fixture and accessories, use the Model Number and Options page.

Example: To specify a Handicap Accessible, Surface Mounted Wall Shower with temp./pressure-balancing mixing valve, diverter valve, standard 2.5 GPM flow rate, APS and FX shower heads, and surface mounted soap dish

Use the following Willoughby Model Number:

**CWSMS-HCA-TPV-DV-2.5-APS-FX-SD**

### Handicap Accessible:

The CWSMS-HCA will conform to most, but not all, ADA requirements; for complete ADA Compliance, see Model No. CWSMS-ADA-WH.

(Compliance shall be subject to the requirements of the local code authority based on installation-specific details and is the responsibility of the installer.)



**WARNING:** Cancer and Reproductive Harm

- [www.P65Warnings.ca.gov](http://www.P65Warnings.ca.gov)

visit our website at [www.willoughby-ind.com](http://www.willoughby-ind.com)  
5105 West 78th Street • Indianapolis, IN. 46268  
(317) 875-0830 • Fax: (317) 875-0837 • (800) 428-4065



MADE IN THE U.S.A.

# MODEL NUMBER AND OPTIONS:

## 1.) Base Model Number:

- CWSMS-HCA Handicap Accessible, Surface Mounted Wall Shower

## 2.) Valve Selection:

- NV No Valve (Provided by Others)  
 Special Hole Punching Dimension:
- 
- PML1 Single Temp. Pneumatic Metering  
 PML2 Dual Temp. Pneumatic Metering  
 E1L1 Single Temp. Electronic (Pick Control)\*  
 E1L2 Dual Temp. Electronic (Pick Control)\*  
 PBV Pressure-Balancing Mixing Valve  
 TPV Temperature Pressure-Balancing Mixing Valve  
 TPLR Ligature-resistant Temperature/Pressure-Balancing Mixing Valve  
 SVCL Single Temp. Compression Valve (w/ ADA lever handle)  
 DVCL Dual Temp. Compression Valves (w/ ADA lever handle)  
 MA2 **Valve Manifold Option** (Pneumatic or Electronic Valves Only):  
*(See the Manifold Option Page at the end of Catalog Section C14 for further information)*

## 3.) Diverter Valve:

- DV Diverter Valve  
 DVLR Ligature-resistant Diverter Valve  
 PML1-MA2 Two Single Temp. Pneumatic Metering Valves  
 (Used to divert water flow to either upper, lower, or both shower heads; for use with Mixing Valve options above)

## 4.) Push Button Selection:

*Pneumatic or Electronic Valves Only:*

- PBH Ligature-resistant Pneumatic Push Buttons\*\*  
 PZPB Ligature-resistant Piezo Electronic Push Buttons\*/\*\*

## 5.) Flow Rates:

- 2.5 GPM (Standard)     2.0 GPM     1.5 GPM

## 6.) Electronic Control\* (Must Use Electronic Push Button):

- WUSC-2200     WUSC-2400     Pneutronic

## 7.) Shower Head Selection:

- APS Adjustable Vandal-resistant Shower Head  
 NPS Non-Adjustable Vandal-resistant Shower Head  
 UBJ Universal Ball Joint Shower Head (2.0 GPM Flow Rate Only)  
 LBJ Lockable Ball Joint Shower Head (2.0 GPM Flow Rate Only)  
 CSH Ligature-resistant Shower Head\*\*  
 FX Hand-held Flexshower Head (w/ quick disconnect, vacuum breaker, and (1) hook) (Standard)  
 LRSH Ligature-resistant Shower Head, WaterSense Labeled Insert (1.5 GPM & 2.0 GPM Flow Rate only) \*\*

## 8.) Other Options:

- TF24H Hard-wired Transformer, 110VAC to 24VAC\* (Standard)  
 TF24P Plug-in Transformer, 110VAC to 24VAC\*  
 TMV Inline Thermostatic Mixing Valve  
 HL Hi-Lo (2 Hooks For Flexshower, Wall Mounted)  
 SLB24 24" Adjustable Slide Bar (for Flexshower, wall mounted)  
 SD Surface Mounted Soap Dish  
 RD Recessed Mounted Soap Dish (Extends housing 5" and will interfere with grab bar installation)  
 PS Pipe Shroud (Specify Length): \_\_\_\_\_  
 (Pipe Shroud option changes Riveted Sloped Top to Flat Top)  
 Other \_\_\_\_\_  
 Other \_\_\_\_\_

\* (Req. 110V power through ground fault interrupter (GFCI) receptacle / breaker)

## \*\*LIGATURE-RESISTANT DISCLAIMER

This product is designed to minimize ligature points. While every effort has been made to reduce the possibility of ligature points, this product does not eliminate all risks. Ligature-Resistant products by Willoughby Industries are to be used in conjunction with, not as a replacement for, trained professionals.

Approved For Manufacturing By: \_\_\_\_\_ Date: \_\_\_\_\_ Company: \_\_\_\_\_  
 Wall Thickness: \_\_\_\_\_ Wall Type: \_\_\_\_\_

**VERIFY ALL DIMENSIONS WITH FACTORY PRIOR TO ROUGH-IN**  
 WILLOUGHBY RESERVES THE RIGHT TO MAKE CHANGES IN DESIGN AND DIMENSIONS WITHOUT FORMAL NOTICE AND WITHOUT INCURRING OBLIGATION.

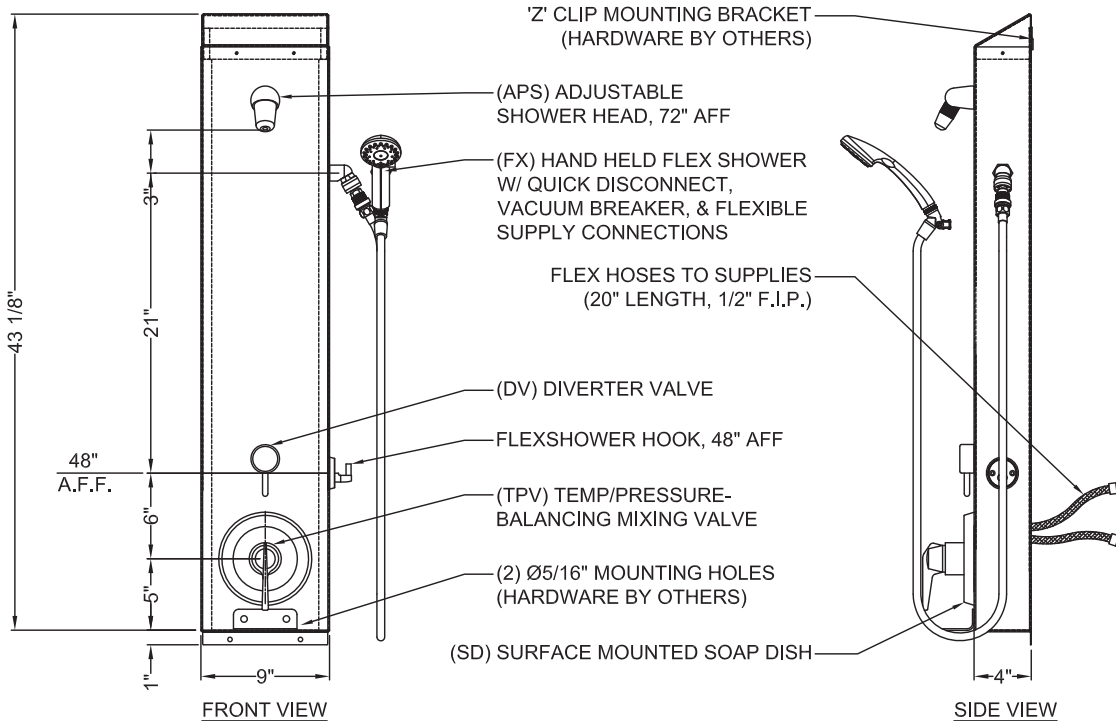

visit our website at [www.willoughby-ind.com](http://www.willoughby-ind.com)  
 5105 West 78th Street • Indianapolis, IN. 46268  
 (317) 875-0830 • Fax: (317) 875-0837 • (800) 428-4065



MADE IN THE U.S.A.